

## INSTALLATION

1. **INSTALL NO. 2 INTERMEDIATE SHAFT ASSEMBLY**
  - (a) Align the matchmarks on the No. 2 intermediate shaft assembly and main shaft assembly.
  - (b) Install the No. 2 intermediate shaft assembly with the bolt.  
**Torque: 28 N·m (290 kgf-cm, 21 ft-lbf)**
2. **INSTALL SLIDING YOKE**  
Temporarily install the sliding yoke to the No. 2 intermediate shaft assembly with the bolt A.
3. **INSTALL STEERING COLUMN ASSEMBLY**
  - (a) Install the steering column assembly with the lower mount bolt and 2 upper mount bolts.  
**Torque: 21 N·m (210 kgf-cm, 15 ft-lbf)**
  - (b) Connect the connectors.

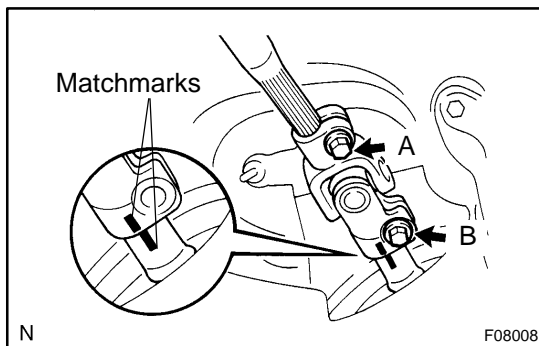

4. **CONNECT SLIDING YOKE**
  - (a) Align the matchmarks on the sliding yoke and No. 3 intermediate shaft assembly.
  - (b) Install the bolt B.  
**Torque: 28 N·m (290 kgf-cm, 21 ft-lbf)**
  - (c) Torque the bolt A.  
**Torque: 28 N·m (290 kgf-cm, 21 ft-lbf)**
5. **INSTALL NO. 2 COLUMN HOLE COVER**  
Install the No. 2 column hole cover with the clip.
6. **A/T:**  
**INSTALL KEY INTERLOCK CABLE**  
(See page [AX-24](#))
7. **INSTALL COLUMN UPPER COVER, LIGHT CONTROL SWITCH AND HEADLIGHT DIMMER SWITCH, WIPER AND WASHER SWITCH AND SPIRAL CABLE**
  - (a) Install the column upper cover.

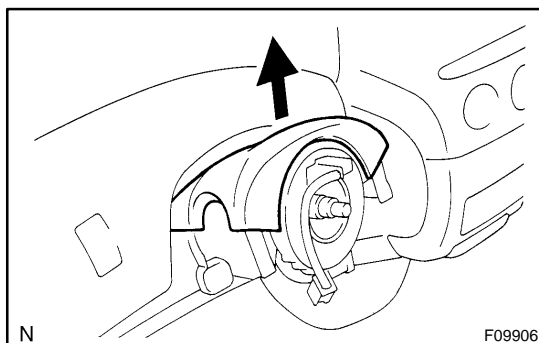

- (b) Slide the column upper cover and install the spiral cable.

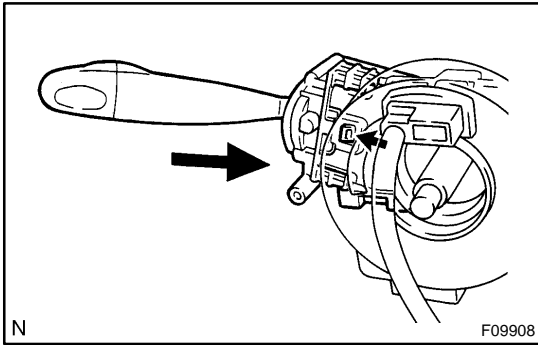

- (c) Push into the light control switch and headlight dimmer switch until the claw is latched.
- (d) Employ the same manner described above to the wiper and washer switch.
- (e) Connect the airbag connector to the spiral cable.
- (f) Connect the 3 connectors to the spiral cable, light control switch and headlight dimmer switch and wiper and washer switch.

**8. INSTALL COLUMN LOWER COVER**

Install the column lower cover with the 3 screws.

**9. CENTER SPIRAL CABLE**

- (a) Check that the front wheels are facing straight ahead.
- (b) Turn the cable counterclockwise by hand until it becomes harder to turn.
- (c) Then rotate the cable clockwise about 2.5 turns to align the marks.

HINT:

The cable will rotate about 2.5 turns to either left or right of the center.

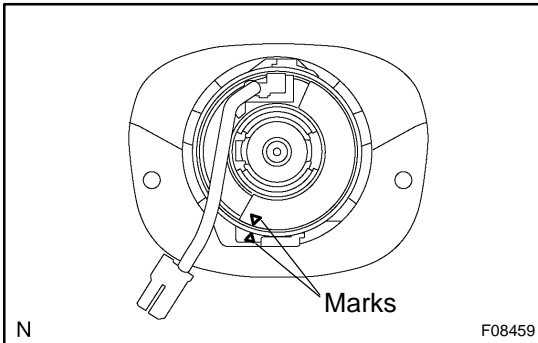

**10. INSTALL STEERING WHEEL**

- (a) Align the matchmarks on the steering wheel and main shaft assembly.
- (b) Install the steering wheel set nut.  
**Torque: 50 N·m (510 kgf-cm, 37 ft-lbf)**

**11. INSTALL STEERING WHEEL PAD**

**NOTICE:**

- **Never use airbag parts from another vehicle. When replacing parts, replace with new ones.**
- **Make sure the wheel pad is installed with the specified torque.**
- **If the wheel pad has been dropped, or there are cracks, dents or other defects in the case or connector, replace the wheel pad with a new one.**
- **When installing the wheel pad, take care that the wirings do not interfere with other parts and that they are not pinched between other parts.**

- (a) Connect the connector.
- (b) Connect the airbag connector.

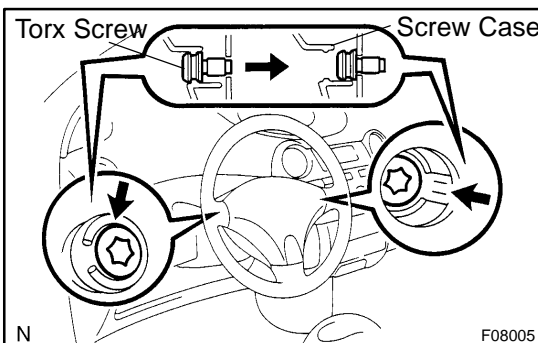

- (c) Install the steering wheel pad after confirming that the circumference groove of the torx screws is caught on the screw case.
- (d) Using a torx socket wrench, torque the 2 screws.  
**Torque: 8.8 N·m (90 kgf-cm, 78 in.-lbf)**

**12. CHECK STEERING WHEEL CENTER POINT**