

REASSEMBLY

NOTICE:

When using a vise, do not overtighten it.

1. COAT PARTS INDICATED BY ARROWS WITH MOLYBDENUM DISULFIDE LITHIUM BASE GREASE (See page [SR-33](#))
2. INSTALL STEERING RACK

NOTICE:

To avoid damaging the bushing, install the rack from the steering pinion side of the rack housing without revolving it.

3. INSTALL STEERING PINION, SPACER AND OIL SEAL
 - (a) Set the notched side of the steering rack so that the pinion can be positioned inside.
 - (b) Push in the steering pinion, and using snap ring pliers, install the snap ring.

NOTICE:

Be careful not to damage the serrations.

- (c) Install the spacer.
- (d) Coat a new oil seal lip with molybdenum disulfide lithium base grease.

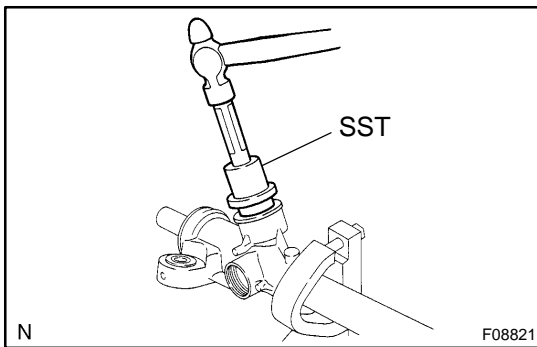

- (e) Using SST and a hammer, tap in the oil seal.
SST 09517-12010

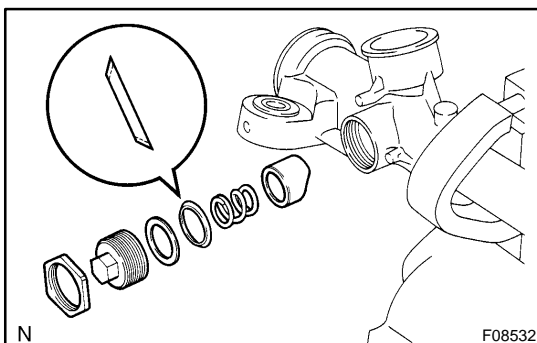

4. INSTALL RACK GUIDE SUB-ASSEMBLY, RACK GUIDE SPRING, CONICAL SPRING WASHER, RACK GUIDE SPRING SPACER AND RACK GUIDE SPRING CAP
 - (a) Install the rack guide sub-assembly, rack guide spring, conical spring washer and rack guide spring spacer.

NOTICE:

Make sure that the conical spring washer is installed facing in the correct direction.

- (b) Apply sealant to 2 or 3 threads of the rack guide spring cap.

Sealant:

Part No. 08833-00080, THREE BOND 1344, LOCTITE 242 or equivalent

- (c) Temporarily install the rack guide spring cap.

5. ADJUST TOTAL PRELOAD

- (a) Temporarily install the RH and LH rack ends.

- (b) Torque the rack guide spring cap.

Torque: 6.9 N·m (70 kgf·cm, 61 in.-lbf)

- (c) Using SST, turn the pinion shaft right and left 1 or 2 times.

SST 09612-24014 (09616-10010)

- (d) Loosen the rack guide spring cap until the rack guide spring is not functioning.

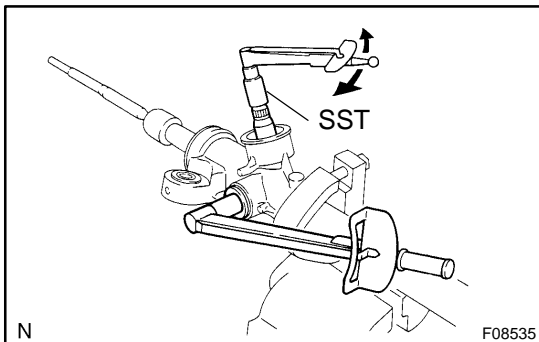
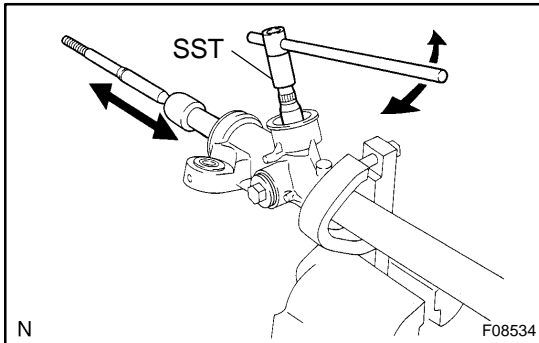

- (e) Using SST and a torque wrench, tighten the rack guide spring cap until the preload is within specification.

SST 09612-24014 (09616-10010)

Preload (turning):

0.6 - 1.5 N·m (6 - 15 kgf·cm, 5.2 - 13.0 in.-lbf)

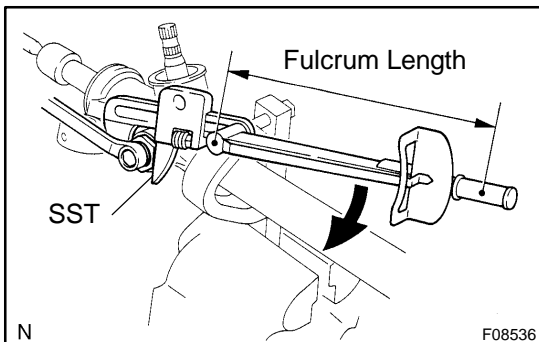

6. INSTALL RACK GUIDE SPRING CAP LOCK NUT

- (a) Apply sealant to 2 or 3 threads of the rack guide spring cap lock nut.

Sealant:

Part No. 08833-00080, THREE BOND 1344, LOCTITE 242 or equivalent

- (b) Hold the rack guide spring cap rotating and using SST, torque the rack guide spring cap lock nut.

SST 09922-10010

Torque: 36 N·m (365 kgf·cm, 26 ft.-lbf)

NOTICE:

Use SST 09922-10010 in the direction shown in the illustration.

HINT:

Use a torque wrench with a fulcrum length of 345 mm (13.58 in.).

- (c) Recheck the total preload.

Preload (turning):

0.6 - 1.5 N·m (6 - 15 kgf·cm, 5.2 - 13.0 in.-lbf)

- (d) Remove the RH and LH rack ends.

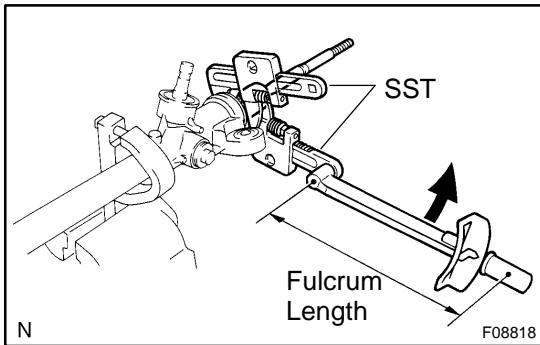

7. INSTALL RH AND LH RACK ENDS

- (a) Using SST, hold the steering rack steadily and using another SST, install the rack end.

SST 09922-10010

Torque: 62 N·m (630 kgf-cm, 46 ft-lbf)

NOTICE:

Use SST 09922-10010 in the direction shown in the illustration.

HINT:

Use a torque wrench with a fulcrum length of 380 mm (14.96 in.).

- (b) Employ the same manner described above to the other side.

8. INSTALL RH AND LH RACK BOOTS, CLAMPS AND CLIPS

- (a) Install the rack boot, clip and a new clamp.

NOTICE:

Be careful not to damage or twist the boot.

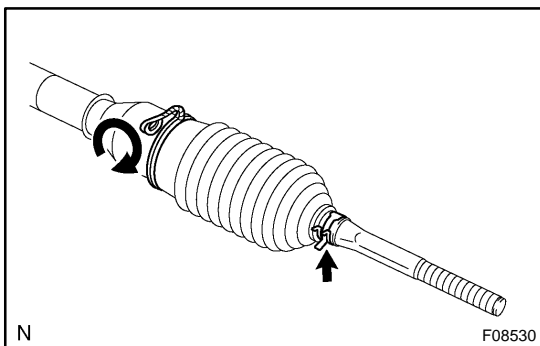

- (b) After winding and tightening the clamp around the circumference of the boot twice, twist it several times, and install it.

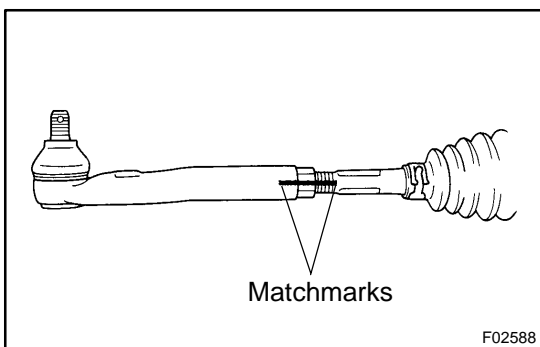

9. INSTALL RH AND LH TIE ROD ENDS AND LOCK NUTS

- (a) Screw the lock nut and tie rod end onto the rack end until the matchmarks are aligned.

- (b) After adjusting toe-in, torque the lock nut (See page SA-5).

Torque: 47 N·m (480 kgf-cm, 35 ft-lbf)

- (c) Employ the same manner described above to the other side.