

INSPECTION

1. **INSPECT TIMING CHAIN AND TIMING SPROCKETS**
 - (a) Using a vernier calipers, measure the length of 16 links with the chain dully stretched.

Maximum chain elongation: 123.2 mm (4.850 in.)

If the elongation is greater than maximum, replace the chain.

HINT:

Make the same measurements pulling at 3 or more places selected at random.

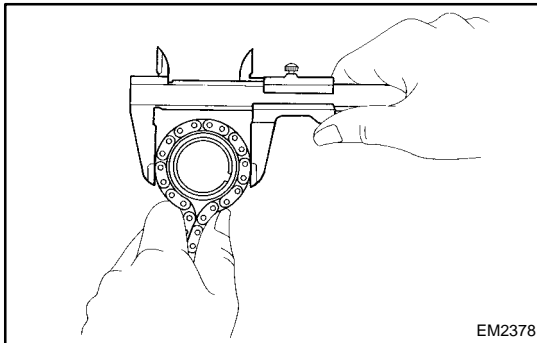

- (b) Wrap the chain around the timing sprocket.
 - (c) Using a vernier calipers, measure the timing sprocket diameter with the chain.

NOTICE:

Vernier calipers must contact the chain rollers for measuring.

Minimum sprocket diameter (w/ Chain):

Camshaft 96.2 mm (3.787 in.)

Crankshaft 50.5 mm (1.988 in.)

If the diameter is less than minimum, replace the chain and sprockets.

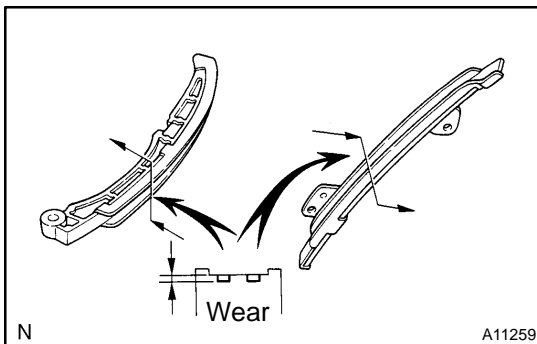

2. INSPECT CHAIN TENSIONER SLIPPER AND VIBRATION DAMPER

Measure the chain tensioner slipper and vibration damper wears.

Maximum wear: 1.0 mm (0.039 in.)

If the wear is greater than maximum, replace the slipper and/or damper.

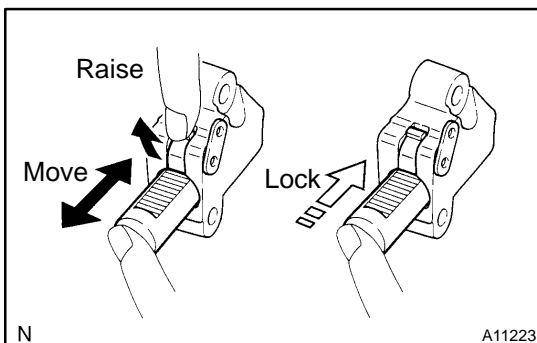

3. INSPECT CHAIN TENSIONER

- (a) Check that the plunger moves smoothly when the ratchet pawl is raised with your finger.
- (b) Release the ratchet pawl and check that the plunger is locked in place by the ratchet pawl and does not move when pushed with your finger.
- (c)