

<b>DTC</b>	<b>P0710</b>	<b>Transmission Fluid Temperature Sensor Malfunction (ATF Temperature Sensor)</b>
------------	--------------	---

<b>DTC</b>	<b>P0711</b>	<b>Transmission Fluid Temperature Sensor Circuit Range/Performance Problem</b>
------------	--------------	--

**CIRCUIT DESCRIPTION**

The ATF temperature sensor converts fluid temperature into a resistance value which is input into the ECM.

DTC No.	DTC Detecting Condition	Trouble Area
P0710	Either (a) or (b) is detected for 0.5 sec. or more. (2-trip detection logic) (a) Temperature sensor resistance is less than 79 Ω (b) After the engine has been operating for 15 minutes or more, the resistance at the temp. sensor is more than 156 kΩ	<ul style="list-style-type: none"> <li>• Open or short in ATF temperature sensor</li> <li>• ATF temperature sensor</li> <li>• ECM</li> </ul>
P0711	Both (a) and (b) is detected. (a) After 12 seconds of the engine start, the temp. of the atmosphere and that of the engine coolant is more than -10 °C. (b) After a normal driving for over 20 minutes and 6.2 miles (10 km), the ATF temp. is less than 10 °C.	<ul style="list-style-type: none"> <li>• Open in ATF temp. sensor circuit</li> <li>• ATF temp. sensor</li> <li>• ECM</li> </ul>

**WIRING DIAGRAM**

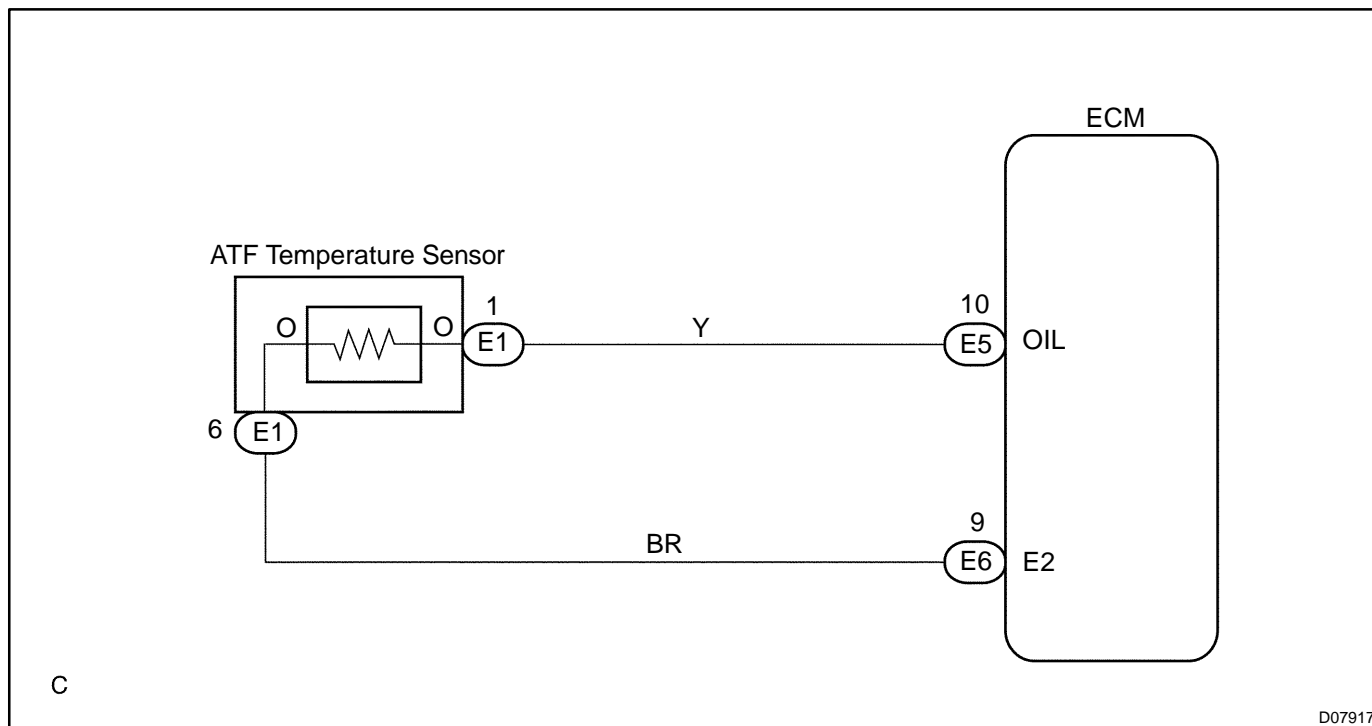

## INSPECTION PROCEDURE

## 1 Check ATF temperature sensor.

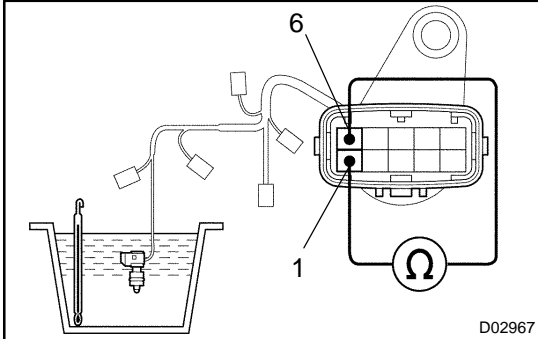
**PREPARATION:**

Remove the solenoid wiring (See page [AX-9](#)).

**CHECK:**

Measure resistance between terminals of ATF temperature sensor at 25 °C (77 °F) and 110 °C (230 °F).

**OK:****Resistance (Approx.):**

25 °C (77 °F): 3.5 kΩ

110 °C (230 °F): 247 Ω

NG

Replace the solenoid wiring.

OK

2 Check harness and connector between solenoid wiring and ECM  
(See page [IN-29](#)).

NG

Repair or replace the harness or connector.

OK

Check and replace the ECM  
(See page [IN-29](#)).