

# AIR INLET SERVOMOTOR INSPECTION

AC28P-03

1. REMOVE FRONT PASSENGER AIRBAG  
(See page [RS-28](#) )

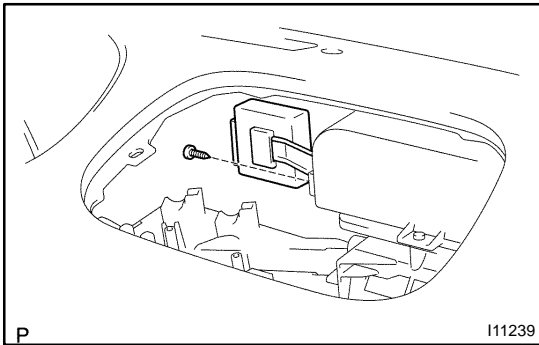

2. REMOVE A/C AMPLIFIER WITH BRACKET
  - (a) Disconnect the connector.
  - (b) Remove the screw and A/C amplifier with bracket.

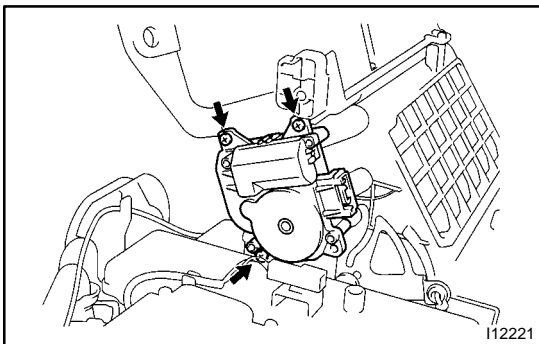

3. REMOVE AIR INLET SERVOMOTOR
  - (a) Disconnect the connector.
  - (b) Remove the 3 screws and servomotor.

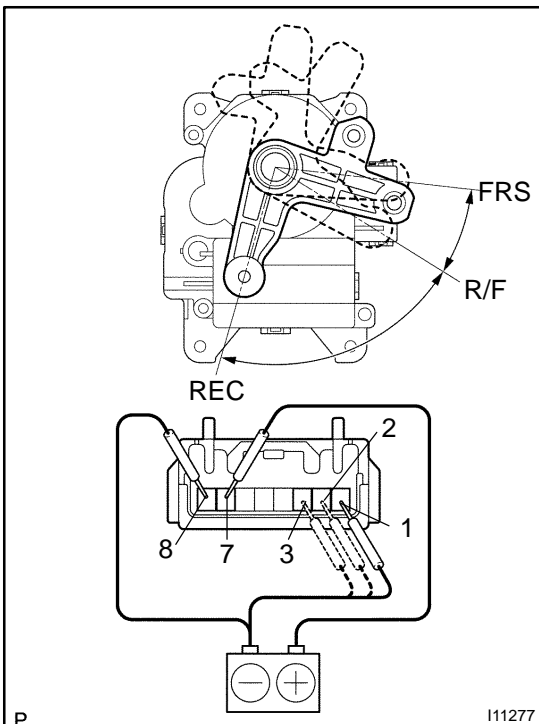

4. INSPECT AIR INLET SERVOMOTOR OPERATION
  - (a) Connect the positive (+) lead from the battery to terminal 7 and the negative (-) lead to terminal 8.
  - (b) Connect the negative (-) lead from the battery to each terminal and check that the shaft rotates at each position, as shown in the chart.

If operation is not as specified, replace the servomotor.

5. INSTALL AIR INLET SERVOMOTOR
6. INSTALL A/C AMPLIFIER WITH BRACKET
7. INSTALL FRONT PASSENGER AIRBAG  
(See page [RS-37](#) )